

# POWERFLEX®

## PART NUMBER

# PFR1-714

## DESCRIPTION

## REAR LOWER SPRING MOUNT OUTER

## INSTALLATION GUIDE

### Contents (parts per pack):

4 x Polyurethane Bushes      1 x PTFE/Silicone Grease  
4 x Washers                      2 x Stainless Steel Sleeves

Please read the complete fitting instructions and check package components before fitment. These fitting instructions are to be used as a guide and in conjunction with workshop manual.

It is recommended that:

- all work to be carried out by a licensed technician;
- all safety precautions adhered to;
- wheel alignment to be checked and adjusted as required after any suspension work.
- All fasteners must be tensioned to manufacturer's torque settings.

### Fitting Instructions:

1. Prise the handbrake cable from its clip and the spring from its pan.
2. Remove the arm from the vehicle and press out the original bush.
3. Clean any dirt or burrs from the bore in the arm, removing any sharp edges with a rounded file.
4. Push the bushes into either side of the arm, shown in Figure 1.
5. Apply some of the supplied PTFE/Silicone grease to the bore and the mounting faces of each bush.
6. Press the Stainless-Steel sleeve into the bushes until flush.
7. The washers should be fitted to the outside of the top hats to support the bush face, shown in Figure 2.
8. Refit the arm to the vehicle with spring etc. and tension all hardware to the manufacturer's recommended torque settings.

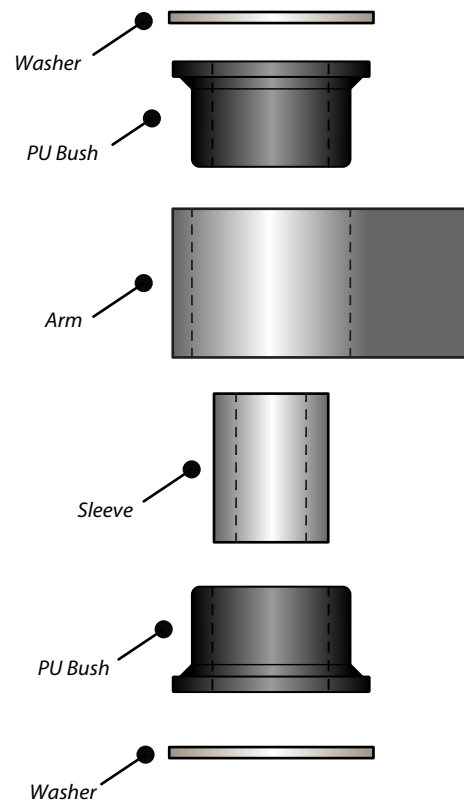

Figure 1



Figure 2